



200907100653 4 PGS
 07/10/2009 3:08pm \$45.00
 PIERCE COUNTY, WASHINGTON

Name & Return Address:

Diane Cooper
SE 130 Lynch Road
Shelton, WA 98584

Please print legibly or type information.

Document Title(s) <u>Notice of Eetgrass Boundary</u>
Grantor(s) <u>Taylor Shellfish Farms</u> ___ Additional Names on Page ___ of Document
Grantee(s) <u>Public, Pierce County</u> ___ Additional Names on Page ___ of Document
Legal Description (Abbreviated: i.e., lot, block & subdivision name or number OR section/township/range and quarter/quarter section) <u>Parts of Twp 21 North, Range 1W, W.M.</u> Complete Legal Description on Page ___ of Document
Auditor's Reference Number(s)
Assessor's Property Tax Parcel/Account Number(s) <u>0021103032, 0021103030, 0021103031</u>
The Auditor/Recorder will rely on the information provided on this cover sheet. The Staff will not read the document to verify the accuracy or completeness of the indexing information provided herein.
I am requesting an emergency nonstandard recording for an additional fee as provided in RCW 36.18.010. I understand that the recording processing requirements may cover up or otherwise obscure some part of the text of the original document.
_____ Signature of Requesting Party (Required for non-standard recordings only) Gpcovst.doc rev 4/02

For reference only, not for re-sale.

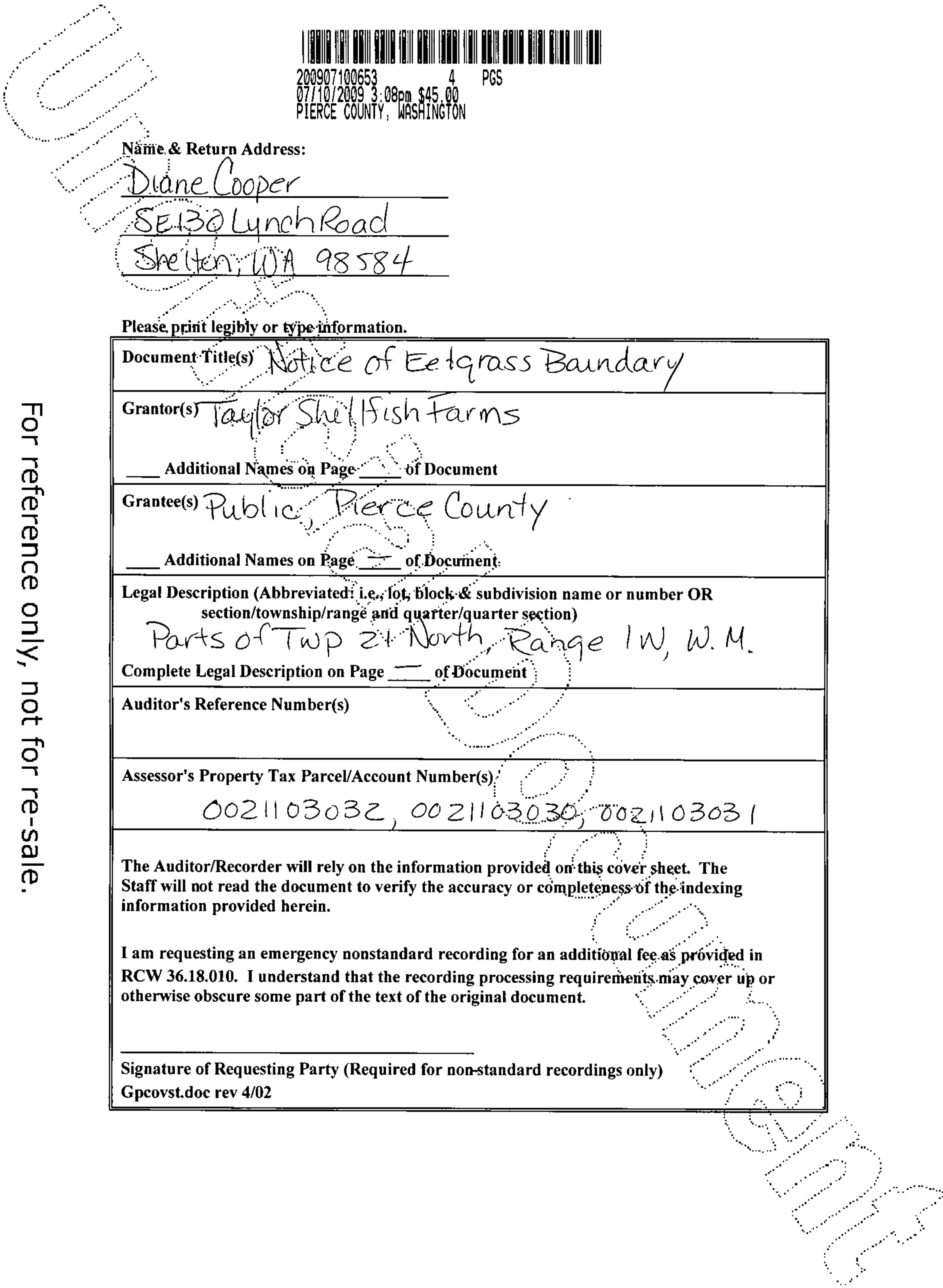

The attached Site Plan establishes boundaries for eelgrass as identified on site by a biological survey and GPS coordinates. This Site Plan was developed for complying with Shoreline Substantial Development Permit Number SD55-05, Condition Number 29, Taylor Shellfish Farms, applicant. This applies to Parcels 0021103030 and 0021103031, David and Sabra Stratford, landowners.

The attached document is entitled: *Taylor Shellfish Stratford-Meyer Geoduck Farm Site Plan Eelgrass Boundaries*

Diane Cooper

7/8/09

Diane Cooper, Taylor Shellfish Farms

Date

For reference only, not for re-sale.

STATE OF WASHINGTON)

:ss.

COUNTY OF MASON)

On this day personally appeared before me *Diane Cooper* to me known to be the person acknowledging the said instrument to be the free and voluntary act and deed for the uses and purposes therein mentioned, and on oath stated that she was authorized to execute said instrument.

GIVEN under my hand and official seal this *8th* day of *July*, 2009.

Patricia G. Bordelon

NOTARY PUBLIC IN AND FOR THE STATE of Washington, residing at *Shelton*



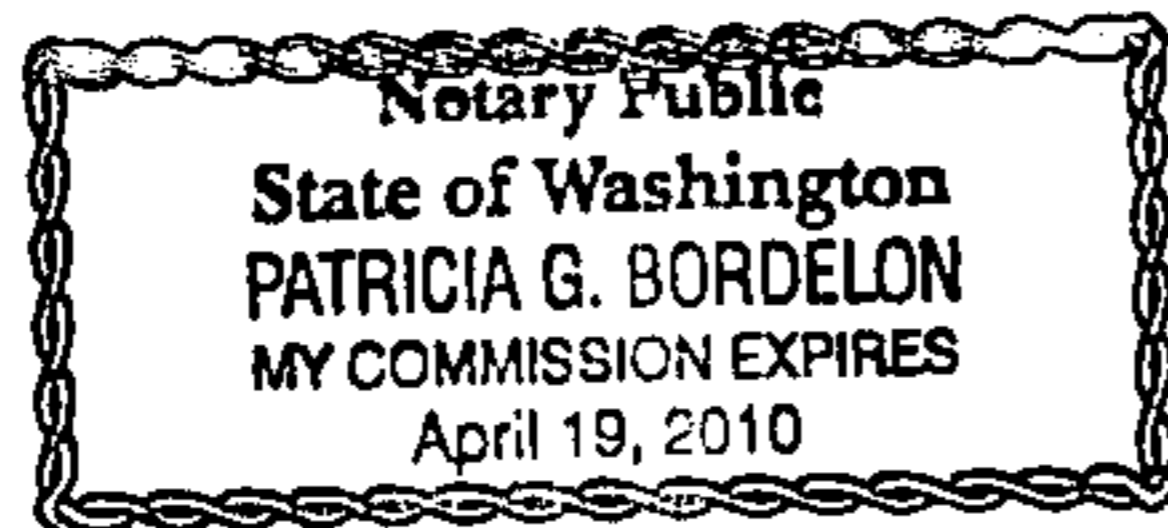

My commission expires: *4-19-2010*

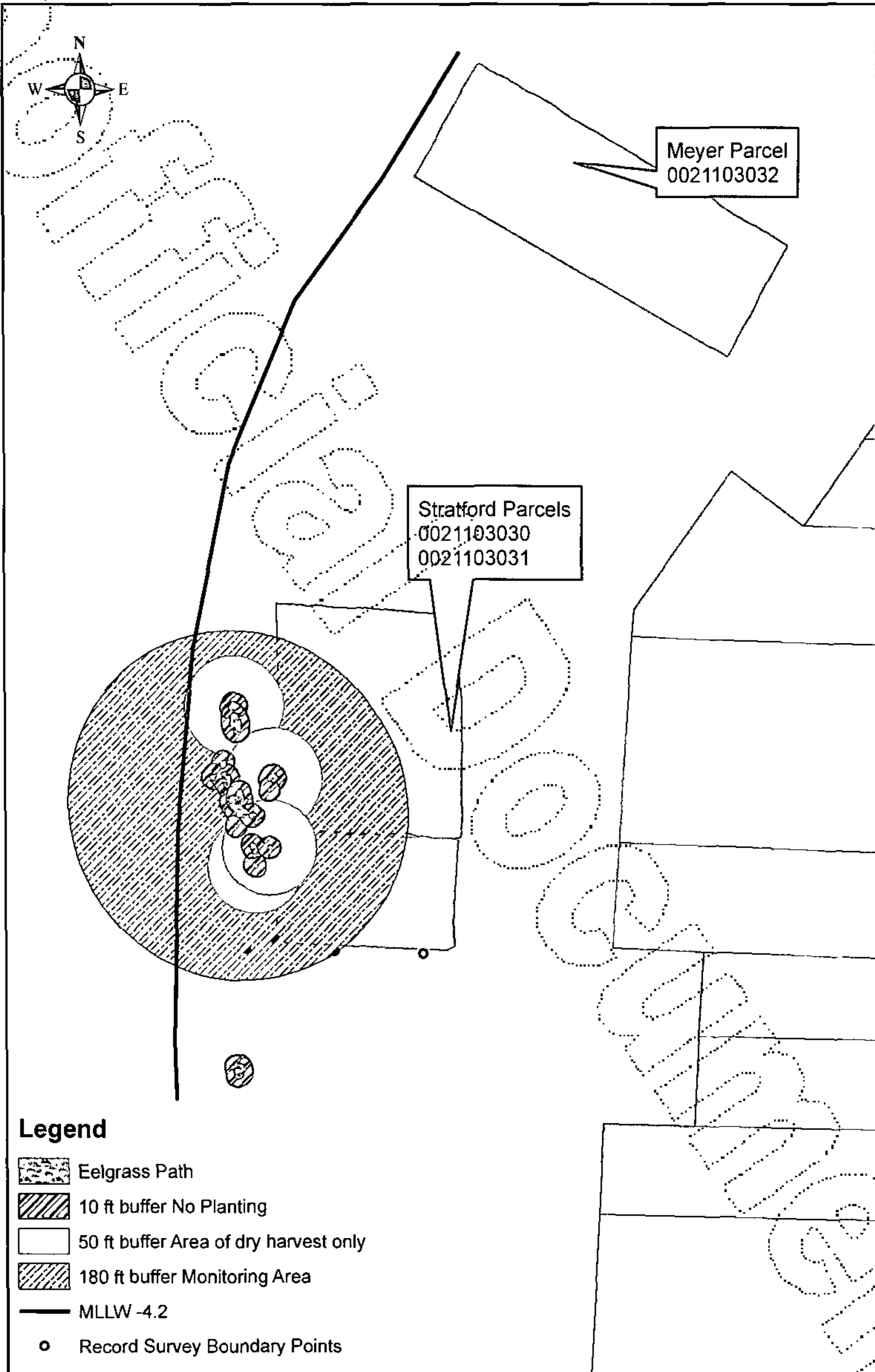

Taylor Shellfish Stratford-Meyer Geoduck Farm Site Plan Eelgrass Boundaries

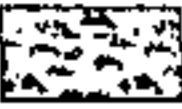

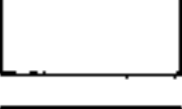
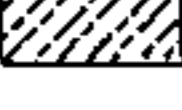
Legend

-  Eelgrass Path
-  10 ft buffer No Planting
-  50 ft buffer Area of dry harvest only
-  180 ft buffer Monitoring Area
-  MLLW -4.2
-  Record Survey Boundary Points



For reference only, not for re-sale.

